

# FLY-R8B



## Passive cardioid subwoofer

FLY-R Series is a passive fixed-curvature line array system designed for small concert venues, theaters, and clubs where compact form factor, accuracy, and controlled performance are required. Based on advanced neodymium technology, the series delivers an industry-leading balance of compact size, high power handling, and sonic clarity. A comprehensive range of mounting accessories provides exceptional deployment flexibility, supporting ground-stacked, flown, and pole-mounted configurations. Flying options are available for both top modules and subwoofers, including combined flown configurations.

The subwoofer FLY-R8B is an advanced low-frequency module engineered for superior directional control and massive output. Featuring a unique six-driver configuration, it utilizes four 8-inch front-firing woofers and two 8-inch rear-firing drivers to achieve an exceptional level of rear cancellation of at least -16 dB. This cardioid behavior significantly reduces unwanted low-frequency energy behind the cabinet, ensuring a cleaner stage and more focused sound in the audience area.



### DIMENSIONS

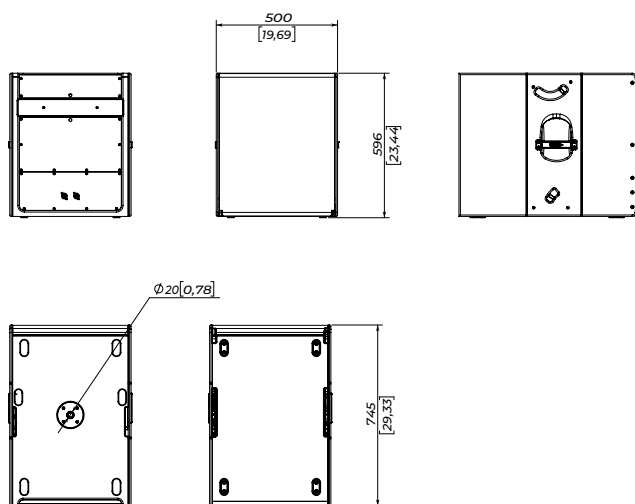

### SPECIFICATIONS

Frequency response (-10dB)	45 - 200 Hz
Max SPL	127 dB
Sensitivity half space (1W/1m)	97 dB
LF Driver	4 × 8", 2.5" VC + 2 × 8", 2.5" VC (rear)
Impedance	4 Ohm + 8 Ohm (rear)
Nominal power	1 000 W + 500 W (rear)
Rear cancellation	no less than -16 dB ref to front
Connector	2 × Speak-on 2 pins
Dimensions (W × H × D)	500 × 596 × 745 mm / 19.59" × 23.44" × 29.33"
Net weight	59 kg
Shipping weight	64 kg
Mounting	M20 distance pole adapters, Integrated flying hardware
Enclosure materials	Plywood; wear-resistant paint
Speaker protection	Steel grill, acoustically transparent backing
Color	Black

### ACCESSORIES

**FLY-R-Bump**  
Flying frame

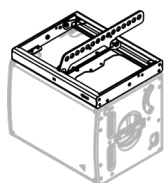

**FLY-R-GS**  
Ground stack Frame

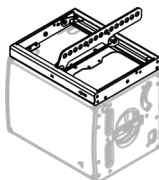

### CONNECTIONS

FLY series powered systems are supplied with CN-0010 PowerCon-E/F CEE 7/7 mains cable (part number 00-00005561). Use only original or supplied by manufacturer mains cables!

FLY series powered systems are equipped with PowerCon B mains power outlets for mains link to additional FLY series powered system.

FLY series systems' nominal mains power specifications: AC 220V, 50/60 Hz.

Nominal voltage tolerance: 100 - 250 V.

For linking the additional system to the same signal bus LINK connector may be used.

### SAFETY INSTRUCTIONS

1. Do not pour liquids on speaker system - this may cause driver cone destruction and unappealing speaker appearance. Do not allow direct sunlight on speaker cone in order to prevent premature failure. Do not install speaker system near open flames or heating elements.
2. Do not use speaker system with damaged speakON or speaker cable so as not to cause electric shock hazard or fire hazard.
3. Make sure speaker system is firmly set up on the floor, stage, or wall (where applicable).
4. While setting speaker system up onto an angled or slippery surface, make the necessary arrangements to avoid vibration-induced movement.
5. Speaker system is capable of delivering significant sound pressure levels. To avoid permanent or temporary hearing damage, prolonged exposure to sound pressure levels exceeding 90 dB should be limited.